

Presented By: Kenneth Schmidt  
Windermere RE Lane County

Client Full

RESIDENTIAL Status: ACT 3/16/2010 4:00:37 PM  
 ML#: 9078714 Area: 239 List Price: \$174,900  
 Addr: 6843 HOLLY ST Unit#:   
 City: Springfield Zip: 97478 Condo Loc/Lvl:   
 Map Coord: 43/J/19 Zoning:   
 County: Lane Tax ID: 1282563  
 Elem: THURSTON Middle: THURSTON  
 High: THURSTON PropType: DETACHD  
 Nhood/Bldg:   
 Legal: 18-02-03-14-00200

**GENERAL INFORMATION**

Lot Size: 5K-6,999SF # Acres: 0.16 Lot Dimensions:   
 Waterfront: View: Lot Desc: CULDSAC  
 River/Lake: Seller Disc: EXEMPT

**RESIDENCE INFORMATION**

Upper SQFT: 729 SFSrc: County rec #Bdrms: 4 #Bth: 3.1 #Lvl: 2 Year Blt: 2004 /  
 Main SQFT: 1623 TotUp/Mn: 2352 Style: 2STORY Green: /  
 Lower SQFT: 0 Parking: DRIVWAY #Garage: 2 / ATTACHD #Fireplaces: 1/ GAS  
 Total SQFT: 2352 Roof: Exterior: MANMADE Bsm/Fnd: CRAWLSP  
 Home Wrnty: 55+ w/Affidavit Y/N:

**REMARKS**

XSt/Dir: Main St,south on S 67th St,east on Ivy,north on S 69th St,west on Holly  
 Public:

**APPROXIMATE ROOM SIZES AND DESCRIPTIONS**

Living: M / /	Mstr Bd: M / /	Baths - Full.Part
Kitchen: / /	2nd Bd: / /	Upper Lvl: 2.0
Dining: / /	3rd Bd: / /	Main Lvl: 1.1
Family: / /	/ /	Lower Lvl: 0.0
/ /	/ /	Total Bth: 3.1

**FEATURES AND UTILITIES**

Kitchen: BI-OVEN  
 Interior: LAM-FL  
 Exterior: FENCED, PATIO, PORCH, VYW-DBL  
 Accessibility:  
 Cool: Hot Water: GAS Heat: FOR-AIR Fuel: GAS  
 Water: PUBLIC Sewer: PUBLIC Insul: CODE

**FINANCIAL**

PTax/Yr: 4578.85 Rent, If Rented: Short Sale: N Bank Owned: Y  
 HOA Dues: Other Dues:  
 HOA Incl:

© RMLS™ 2010. ALL RIGHTS RESERVED. - INFORMATION NOT GUARANTEED AND SHOULD BE VERIFIED.  
 SQUARE FOOTAGE IS APPROXIMATE & MAY INCLUDE BOTH FINISHED & UNFINISHED AREAS - CONSULT BROKER FOR INFO.  
 SCHOOL AVAILABILITY SUBJECT TO CHANGE.

# Foundation Proposal, Contract & Limited Warranty

You're on solid ground with us.



PO Box 909 • Winchester OR 97495 • CCB #173547  
541-229-4049 • 541-229-4051 (fax) • 866-486-7196 Toll Free

Install Date: \_\_\_\_\_  
Right to Lien Given: \_\_\_\_\_  
 No  Yes  
Sold Date: \_\_\_\_\_  
Cust #: \_\_\_\_\_

Proposal Submitted to

Bonnie Bell

Phone (Home)

541 514-0239

Address

Phone (Cell/Work)

City, State, Zip

Job Location

6843 Holly St Springfield OR

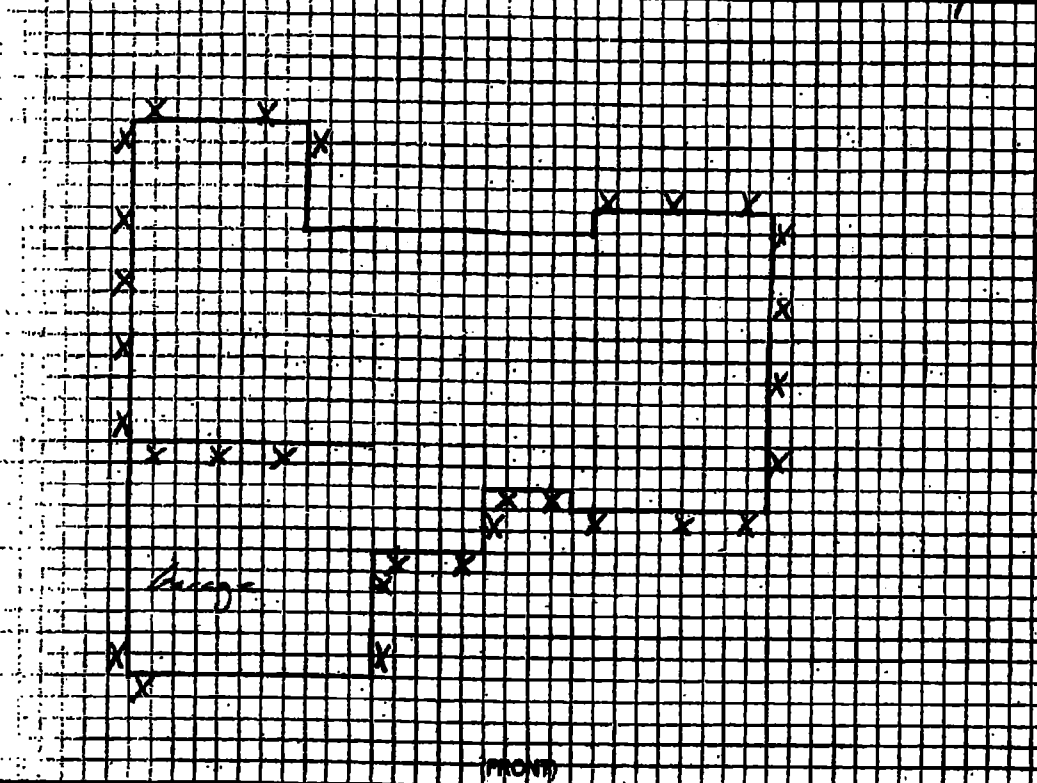

Rec.	Dec.	Qty.	System Features
		<u>30</u>	3" Push Piers
			3" Helical Piers
			New Construction
			Slab Piers
			Tile-Backs
			Stabilizers
			Wall Anchors
			Excavation
			Misc-1
			Misc-2

TerraFirma Foundation Systems, Inc. will install products to walls as shown on diagram, and as follows:

\_\_\_ North, \_\_\_ South, \_\_\_ East, \_\_\_ West  
Include 1 torque wrench for maintaining approximately \_\_\_ lbs of resistance on each anchor.

Amount of Bid: \$40,000.00  
Date: 11-17-09  
This Bid expires 120 days from this date.

TerraFirma Foundation Systems, Inc. will install Foundation Piers to foundation as shown on diagram. Excavate as necessary to the bottom of the footing, install bracket, and drive steel piers to load bearing strata. Stabilize and/or lift foundation as possible, backfill and tamp. Comments:

All proposals based primarily on homeowner's description of problem. An additional charge of \$\_\_\_\_\_ will be added to the proposed amount if work area is not cleared. Homeowner is responsible for removing and replacing objects in the work area. Any alteration or deviation from specifications involving extra cost will be executed only in authorized written form by the homeowner. Unforeseen objects may result in additional charges. Engineering and permit costs are not included and will be billed as an extra if applicable.

Acceptance of Proposal. The prices proposed, specifications and conditions are satisfactory and are hereby accepted. You are authorized to do the work as specified. We jointly and separately agree to pay the installation crew upon completion of the job, and will further pay your service charge of 1.5% per month (18% per annum) if our account is 10 or more days past due, and any attorney's fees and costs to collect or enforce this contract. An additional 3% service fee will be added to ALL credit card transactions. We also agree that there is a three day right to cancel. If this contract is cancelled after the third day we agree to pay a 20% restocking fee plus any engineering or permitting costs incurred. \*\*My signed contract indicates I have read this contract and understand the Limited Warranty on the reverse side, that I accept the terms of the Proposal and Limited Warranty, and that I grant approval to attempt lifting of my home.

Please read this carefully, sign and return an original to our office to accept this contract.

[Signature]

Representative Signature

Authorized Signature

Date